

Instruction Manual



CAL. 2014 (R23 SERIES)



CHARACTERISTICS

- Analogue & digital time displays:** Hour, Minute, Second, Month, Date and day of the week.
- Time Indication:** 12-hour display format with PM indicator and 24-hour display format are available.
- Daily alarm:** The alarm can be set to sound at the designated time on a 24-hour basis.
- Chime:** The chime can be set to sound every hour on the hour with a single beep.
- Stopwatch:** The stopwatch can measure up to 23 hours 59 minutes and 59 seconds in 1/100-second increments. Lap time measurement is available.
- 100 M Water Resistant**
- Illuminating light:** The built-in electro-luminescent (EL) backlight illuminates the display for easy viewing in darkness.

DISPLAY AND BUTTON OPERATION

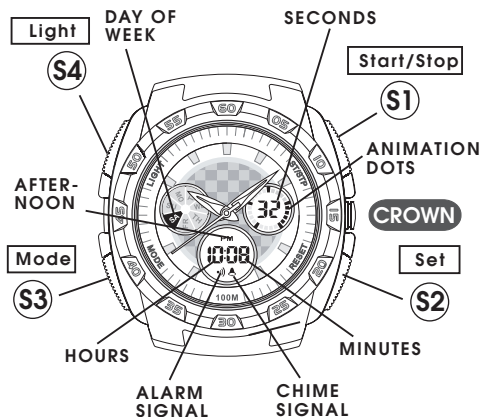

- * Press S2 button and hold to show the ALARM TIME. Release S2 button to return to the NORMAL TIME display.
- * Press S1 button and hold to show the MONTH/DATE or DATE/MONTH. Release S2 button to return to the NORMAL TIME display.
- * Press S3 button at any time to return to the NORMAL TIME display.

SETTING THE TIME (ANALOGUE)

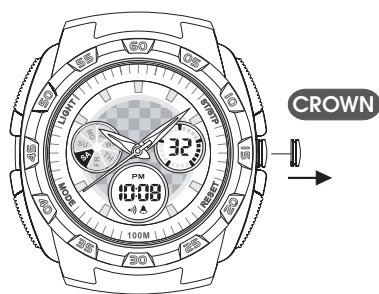

- Pull the crown out one step, the second hand will stop.
- Set the correct time by turning the crown.
- Push the crown back to the original position. The watch will start running again.

* The analogue indication and digital display of the time setting can be adjusted separately.

HOW TO SET NORMAL TIME

- From NORMAL TIME display, press and hold S3 button for 2 seconds to show the ALARM TIME display. The hour digits start flashing.
- The display is changed automatically to the ALARM TIME after 2 seconds.
- Press S3 button again to move on to SECONDS setting. The second digits start flashing.
- Press S2 button to set SECONDS setting.
- Press S1 button to move on to MINUTES setting.
- Selection of the digits to be adjusted (flashing) is made in the order below by pressing S1 button and then pressing S2 button to be set.
- After all the adjustment are completed, press S3 button to return to the NORMAL TIME display.

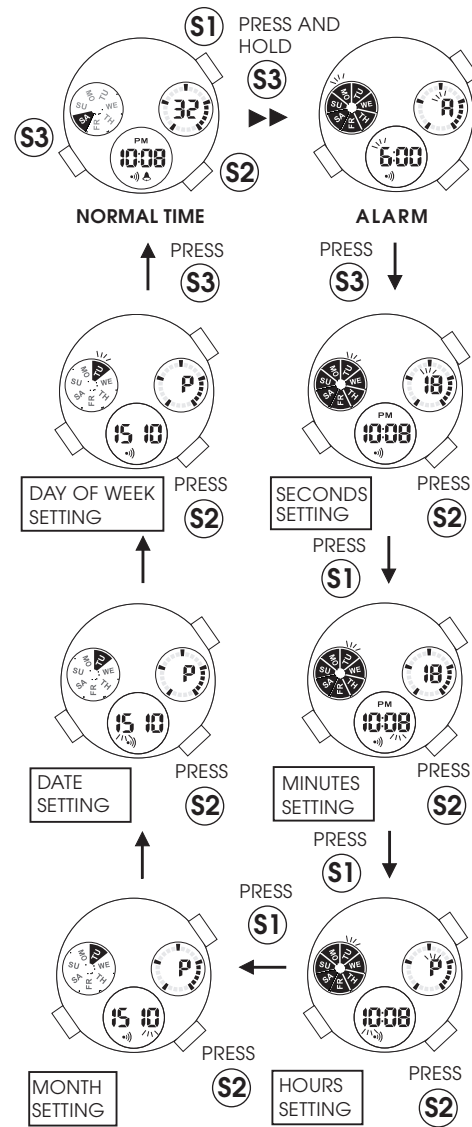

HOW TO SWITCH 12-HOUR/24-HOUR FORMAT

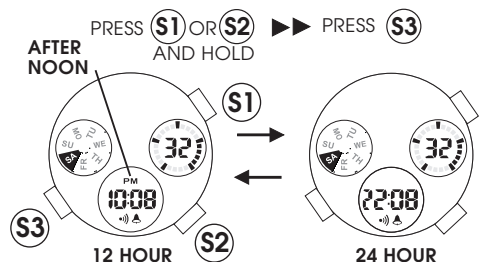

- Press S1 or S2 button and hold it. Then press S3 button to switch the display.
- The time display format in either 12-hour indication or in 24-hour indication can be selected alternately.
- Under the 12-hour indication format, "PM" mark appears in the afternoon, but no AM mark appears in the morning. Under the 24-hour indication format, no mark appears on the display.

HOW TO DISPLAY MONTH/DATE

- From NORMAL TIME display, press S1 button and hold it to show the MONTH/DATE display.
- Press S2 button to switch to the DATE/MONTH display.
- Press S2 button again to switch back to the MONTH/DATE display.
- The display format in either DATE/MONTH indication or in MONTH/DATE indication can be selected alternately by pressing S2 button.

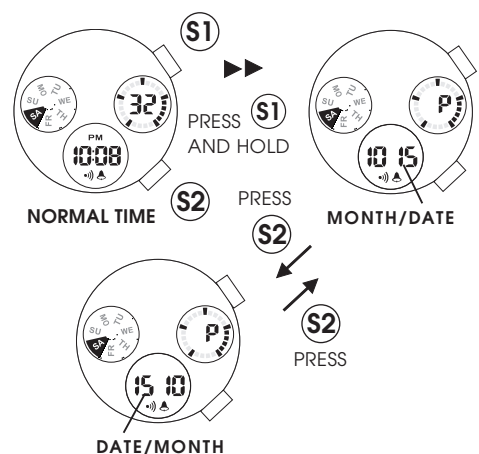

HOW TO SET ALARM TIME

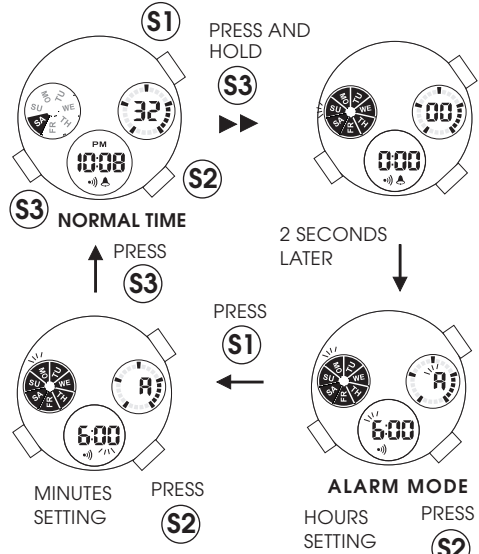

- From NORMAL TIME display, press and hold S3 button for 2 seconds to show the ALARM TIME display. The hour digits start flashing.
- The display is changed automatically to the ALARM TIME after 2 seconds.
- Press S2 button to set HOURS setting.
- Press S1 button to move on to MINUTES setting.
- Press S2 button to set MINUTES setting.
- After all the setting are completed, press S3 button to return to the NORMAL TIME display.

Engagement/Disengagement of ALARM & CHIME

- * Press S2 button and hold it, and then press S1 button, the ALARM and CHIME can be engaged or disengaged in the order below.
- * The ALARM signal and/or CHIME signal appear or disappear on the display accordingly.

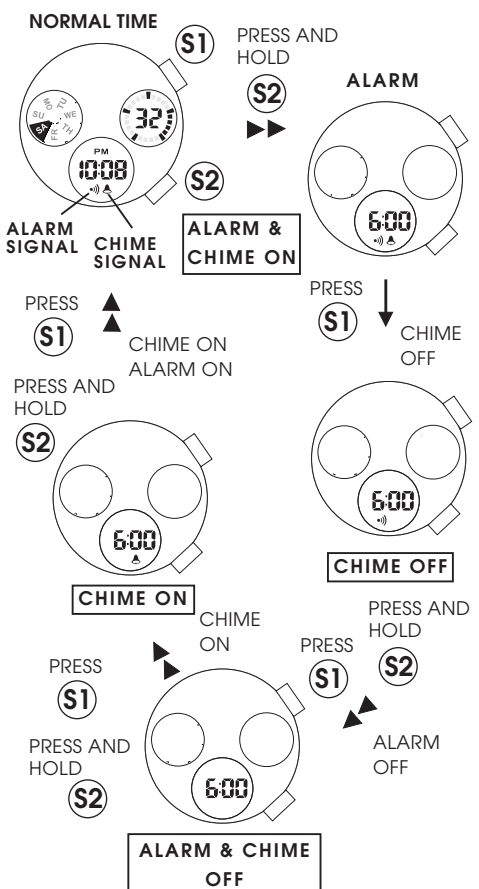

■ HOW TO USE STOPWATCH

* From NORMAL TIME display, press S3 button to go to the STOPWATCH mode.

STOPWATCH MODE

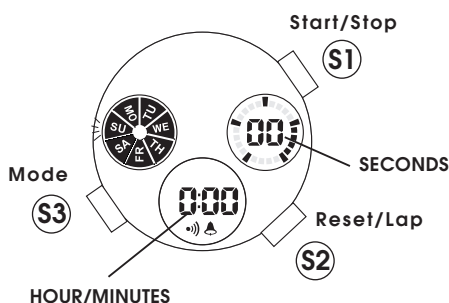

Standard Measurement

1. Press S1 to start and stop the STOPWATCH.
2. Press S2 button to reset the STOPWATCH to "0:00: 00."



Start Stop Reset

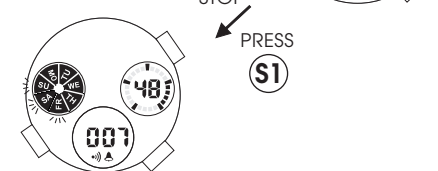
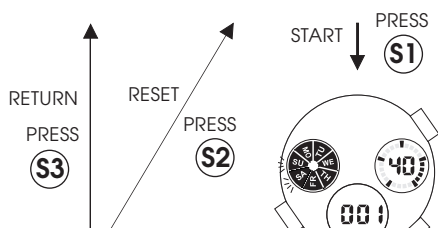
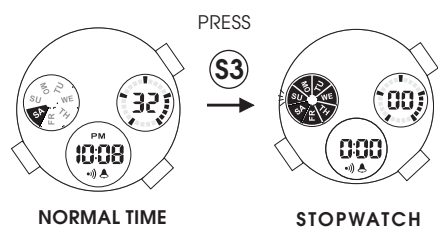

Lap Time Measurement



Start Lap 1 Lap 2 Stop Reset

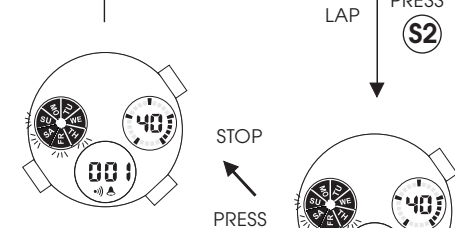
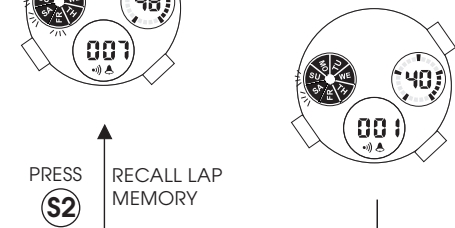
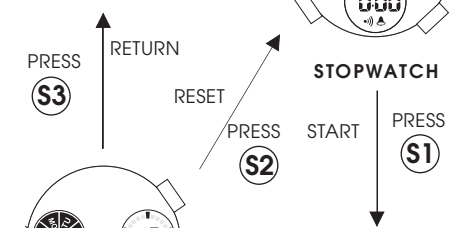
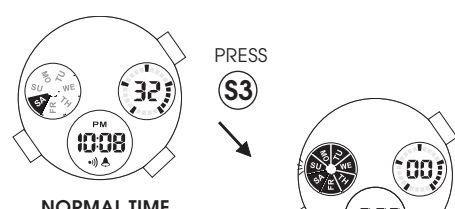

- * While the stopwatch is measuring, press S2 button to take lap times.
- * Measurement and release of lap times can be repeated when S2 button is pressed.

HOW TO RECALL THE LAP TIME DATA

Lap time data obtained in the STOPWATCH mode can be recalled after measurement.

After stopping the stopwatch, press S2 button to view the recorded lap times.

The lap times will be displayed one after another with each press of the button.

- * Press S3 button to return to the NORMAL TIME display.

■ HOW TO USE EL BACKLIGHT

* In NORMAL TIME display, press S4 button to illuminate the display.

PRESS

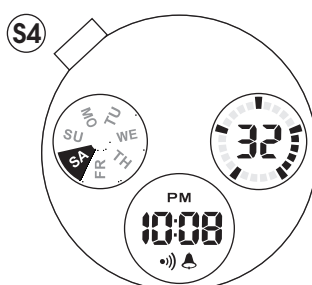

Note:

1. The backlight of the watch employs an electro-luminescent (EL) light, which tends to lose illuminating power after very long use.
 2. The illumination provided by backlight may be hard to see when viewed under direct sunlight.
- * When the illuminating light becomes dim, replace the batteries with new ones.

■ BATTERY CHANGE

1. The miniature battery SEIKO CR2016, Maxell CR2016 or SONY CR2016, which powers your watch, should last approximately 2 years. However, because it is inserted at the factory, the actual life of the battery once in your possession may be less than 2 years.
2. Be sure to replace the battery to prevent any possible malfunction as soon as it runs down.
3. To replace the battery we recommend taking the watch to a local watch repair shop.

Note:

If the alarm is used for more than 20 seconds a day and/or the illuminating light for more than 8 seconds a day, the battery life may be less than the specified period.

■ CARE OF YOUR LORUS WATCH

This watch contains precise electronic components. Never attempt to open the case or remove the back cover.

• BATTERY

CAUTION

Do not expose the old battery to fire or recharge it. Keep it at a place beyond the reach of children. If a child swallows it, consult a doctor immediately.

• WATER RESISTANT

Condition of use	Accidental contact with water, such as splashes and rain	Swimming and taking a shower	Skin diving	Scuba diving
No Indication on the dial/case back	NO	NO	NO	NO
WATER RESISTANT	YES	NO	NO	NO
WATER RESISTANT (50M/5 BAR)	YES	YES	NO	NO
WATER RESISTANT (100M/10 BAR or above)	YES	YES	YES	NO

* If your watch is 200 M/20 BAR, 100 M/10 BAR or 50 M/5 BAR water resistant, it is so indicated on the dial/case back.

- Do not operate the buttons when the watch is wet.
- If the watch is exposed to salt water, rinse it in fresh water and then wipe it thoroughly dry.
- Should you find any water or condensation inside the watch, immediately have it checked. Water can corrode electric parts inside the case.

Caution:

Leather straps are not water resistant except so indicated, even if the watch head is water resistant.

• ALLERGIC REACTION

Because the case and band touch the skin directly, it is important to clean them regularly. If not, shirt sleeves may be stained and those with delicate skin may develop a rash. Please wear the watch with some play to avoid any possible allergic reaction. If you develop a rash on your wrist, stop wearing and consult a physician.

• MAGNETISM

Your watch will be adversely affected by strong magnetism. Keep it away from close contact with magnetic objects.

• SHOCKS AND VIBRATIONS

Your watch may be worn for normal sports activities, but be careful not to drop it or hit it on hard surfaces.

• TEMPERATURE

Your watch is preadjusted so that constant accuracy may be insured at normal temperature.

• CLEANING

Use only a soft cloth and clean water for cleaning your watch. Never use chemicals, as the water-proof gasket will corrode.

■ SERVICE

When your LORUS watch requires repair or servicing, please see the enclosed WARRANTY/GUARANTEE.